

**Application for a premises licence to be granted
under the Licensing Act 2003**

PLEASE READ THE FOLLOWING INSTRUCTIONS FIRST

Before completing this form please read the guidance notes at the end of the form. If you are completing this form by hand please write legibly in block capitals. In all cases ensure that your answers are inside the boxes and written in black ink. Use additional sheets if necessary.

You may wish to keep a copy of the completed form for your records.

I/We ENES SANLI

(Insert name(s) of applicant)

apply for a premises licence under section 17 of the Licensing Act 2003 for the premises described in Part 1 below (the premises) and I/we are making this application to you as the relevant licensing authority in accordance with section 12 of the Licensing Act 2003

Part 1 – Premises details

Postal address of premises or, if none, ordnance survey map reference or description 38 HIGH ROAD			
Post town	EPPING	Postcode	CM16 6BU
Telephone number at premises (if any)			
Non-domestic rateable value of premises		£12,874.00	

Part 2 - Applicant details

Please state whether you are applying for a premises licence as Please tick as appropriate

- | | |
|--|---|
| a) an individual or individuals * | <input checked="" type="checkbox"/> please complete section (A) |
| b) a person other than an individual * | |
| i as a limited company/limited liability partnership | <input type="checkbox"/> please complete section (B) |
| ii as a partnership (other than limited liability) | <input type="checkbox"/> please complete section (B) |
| iii as an unincorporated association or | <input type="checkbox"/> please complete section (B) |
| iv other (for example a statutory corporation) | <input type="checkbox"/> please complete section (B) |
| c) a recognised club | <input type="checkbox"/> please complete section (B) |
| d) a charity | <input type="checkbox"/> please complete section (B) |

- c) the proprietor of an educational establishment ☐ please complete section (B)
- f) a health service body ☐ please complete section (B)
- g) a person who is registered under Part 2 of the Care Standards Act 2000 (c14) in respect of an independent hospital in Wales ☐ please complete section (B)
- ga) a person who is registered under Chapter 2 of Part 1 of the Health and Social Care Act 2008 (within the meaning of that Part) in an independent hospital in England ☐ please complete section (B)
- h) the chief officer of police of a police force in England and Wales ☐ please complete section (B)

* If you are applying as a person described in (a) or (b) please confirm (by ticking yes to one box below)

I am carrying on or proposing to carry on a business which involves the use of the premises for licensable activities, or ☒

I am making the application pursuant to a
 statutory function or ☐
 a function discharged by virtue of Her Majesty's prerogative ☐

(A) INDIVIDUAL APPLICANTS (fill in as applicable)

Mr <input checked="" type="checkbox"/>	Mrs <input type="checkbox"/>	Miss <input type="checkbox"/>	Ms <input type="checkbox"/>	Other Title (for example, Rev)	
Surname SANLI		First names SANLI			
Date of birth over [REDACTED]		I am 18 years old or over <input checked="" type="checkbox"/>		Please tick yes	
Nationality: TURKISH					
Current residential address if different from premises address		[REDACTED]			
Post town [REDACTED]		Postcode [REDACTED]			
Daytime contact telephone number [REDACTED]					
E-mail address (optional) [REDACTED]					

SECOND INDIVIDUAL APPLICANT (if applicable)

Mr <input type="checkbox"/>	Mrs <input type="checkbox"/>	Miss <input type="checkbox"/>	Ms <input type="checkbox"/>	Other Title (for example, Rev)	
-----------------------------	------------------------------	-------------------------------	-----------------------------	--------------------------------	--

Surname		First names	
Date of birth over		I am 18 years old or <input type="checkbox"/> Please tick yes	
Nationality			
Current residential address if different from premises address			
Post town		Postcode	
Daytime contact telephone number			
E-mail address (optional)			

(B) OTHER APPLICANTS

Please provide name and registered address of applicant in full. Where appropriate please give any registered number. In the case of a partnership or other joint venture (other than a body corporate), please give the name and address of each party concerned.

Name
Address
Registered number (where applicable)
Description of applicant (for example, partnership, company, unincorporated association etc.)
Telephone number (if any)
E-mail address (optional)

Part 3 Operating Schedule

When do you want the premises licence to start?

DD	MM	YYYY
2	8	11 22 02 11

If you wish the licence to be valid only for a limited period, when do you want it to end?

DD	MM	YYYY

Please give a general description of the premises (please read guidance note 1)

If 5,000 or more people are expected to attend the premises at any one time, please state the number expected to attend

What licensable activities do you intend to carry on from the premises?

(please see sections 1 and 14 and Schedules 1 and 2 to the Licensing Act 2003)

Provision of regulated entertainment (please read guidance note 2)

Please tick all that apply

- a) plays (if ticking yes, fill in box A) ☐
- b) films (if ticking yes, fill in box B) ☐
- c) indoor sporting events (if ticking yes, fill in box C) ☐
- d) boxing or wrestling entertainment (if ticking yes, fill in box D) ☐
- e) live music (if ticking yes, fill in box E) ☐
- f) recorded music (if ticking yes, fill in box F) ☐
- g) performances of dance (if ticking yes, fill in box G) ☐
- h) anything of a similar description to that falling within (e), (f) or (g) (if ticking yes, fill in box H) ☐

Provision of late night refreshment (if ticking yes, fill in box I)

☐

Supply of alcohol (if ticking yes, fill in box J)

☒

In all cases complete boxes K, L and M

A

Plays Standard days and timings (please read guidance note 7)			<u>Will the performance of a play take place indoors or outdoors or both – please tick</u> (please read guidance note 3)	Indoors	<input type="checkbox"/>
				Outdoors	<input type="checkbox"/>
				Both	<input type="checkbox"/>
Day	Start	Finish	<u>Please give further details here</u> (please read guidance note 4)		
Mon					
Tue					
Wed			<u>State any seasonal variations for performing plays</u> (please read guidance note 5)		
Thur					
Fri			<u>Non standard timings. Where you intend to use the premises for the performance of plays at different times to those listed in the column on the left, please list</u> (please read guidance note 6)		
Sat					
Sun					

B

Films Standard days and timings (please read guidance note 7)			Will the exhibition of films take place indoors or outdoors or both – please tick (please read guidance note 3)	Indoors	<input type="checkbox"/>
				Outdoors	<input type="checkbox"/>
Day	Start	Finish		Both	<input type="checkbox"/>
Mon			<u>Please give further details here</u> (please read guidance note 4)		
Tue					
Wed			<u>State any seasonal variations for the exhibition of films</u> (please read guidance note 5)		
Thur					
Fri			<u>Non standard timings. Where you intend to use the premises for the exhibition of films at different times to those listed in the column on the left, please list</u> (please read guidance note 6)		
Sat					
Sun					

C

Indoor sporting events Standard days and timings (please read guidance note 7)			Please give further details (please read guidance note 4)
Day	Start	Finish	
Mon			
Tue			State any seasonal variations for indoor sporting events (please read guidance note 5)
Wed			
Thur			Non standard timings. Where you intend to use the premises for indoor sporting events at different times to those listed in the column on the left, please list (please read guidance note 6)
Fri			
Sat			
Sun			

D

Boxing or wrestling entertainments Standard days and timings (please read guidance note 7)			<u>Will the boxing or wrestling entertainment take place indoors or outdoors or both – please tick (please read guidance note 3)</u>		Indoors	<input type="checkbox"/>
					Outdoors	<input type="checkbox"/>
					Both	<input type="checkbox"/>
Day	Start	Finish	<u>Please give further details here (please read guidance note 4)</u>			
Mon						
Tue						
Wed			<u>State any seasonal variations for boxing or wrestling entertainment (please read guidance note 5)</u>			
Thur						
Fri						
Sat			<u>Non standard timings. Where you intend to use the premises for boxing or wrestling entertainment at different times to those listed in the column on the left, please list (please read guidance note 6)</u>			
Sun						

E

Live music Standard days and timings (please read guidance note 7)			Will the performance of live music take place indoors or outdoors or both – please tick (please read guidance note 3)	Indoors	<input type="checkbox"/>
				Outdoors	<input type="checkbox"/>
				Both	<input type="checkbox"/>
Day	Start	Finish	Please give further details here (please read guidance note 4)		
Mon					
Tue					
Wed			State any seasonal variations for the performance of live music (please read guidance note 5)		
Thur					
Fri					
Sat			Non standard timings. Where you intend to use the premises for the performance of live music at different times to those listed in the column on the left, please list (please read guidance note 6)		
Sun					

F

Recorded music Standard days and timings (please read guidance note 7)			<u>Will the playing of recorded music take place indoors or outdoors or both – please tick</u> (please read guidance note 3)	Indoors	<input type="checkbox"/>
				Outdoors	<input type="checkbox"/>
				Both	<input type="checkbox"/>
Day	Start	Finish	<u>Please give further details here</u> (please read guidance note 4)		
Mon					
Tue					
Wed			<u>State any seasonal variations for the playing of recorded music</u> (please read guidance note 5)		
Thur					
Fri			<u>Non standard timings. Where you intend to use the premises for the playing of recorded music at different times to those listed in the column on the left, please list</u> (please read guidance note 6)		
Sat					
Sun					

G

Performances of dance Standard days and timings (please read guidance note 7)			Will the performance of dance take place indoors or outdoors or both – please tick (please read guidance note 3)	
			Indoors	<input type="checkbox"/>
			Outdoors	<input type="checkbox"/>
			Both	<input type="checkbox"/>
Day	Start	Finish		
Mon			<u>Please give further details here</u> (please read guidance note 4)	
Tue				
Wed			<u>State any seasonal variations for the performance of dance</u> (please read guidance note 5)	
Thur				
Fri			<u>Nonstandard timings. Where you intend to use the premises for the performance of dance at different times to those listed in the column on the left, please list</u> (please read guidance note 6)	
Sat				
Sun				

H

Anything of a similar description to that falling within (c), (f) or (g) Standard days and timings (please read guidance note 7)			Please give a description of the type of entertainment you will be providing	
Day	Start	Finish	<u>Will this entertainment take place indoors or outdoors or both – please tick</u> (please read guidance note 3)	Indoors <input type="checkbox"/>
Mon				Outdoors <input type="checkbox"/>
				Both <input type="checkbox"/>
Tue			<u>Please give further details here</u> (please read guidance note 4)	
Wed				
Thur			<u>State any seasonal variations for entertainment of a similar description to that falling within (c), (f) or (g)</u> (please read guidance note 5)	
Fri				
Sat			<u>Non standard timings. Where you intend to use the premises for the entertainment of a similar description to that falling within (c), (f) or (g) at different times to those listed in the column on the left, please list</u> (please read guidance note 6)	
Sun				

Late night refreshment Standard days and timings (please read guidance note 7)			Will the provision of late night refreshment take place indoors or outdoors or both – please tick (please read guidance note 3)	Indoors	<input type="checkbox"/>
				Outdoors	<input type="checkbox"/>
				Both	<input type="checkbox"/>
Day	Start	Finish	<u>Please give further details here</u> (please read guidance note 4)		
Mon					
Tue					
Wed			<u>State any seasonal variations for the provision of late night refreshment</u> (please read guidance note 5)		
Thur					
Fri			<u>Non standard timings. Where you intend to use the premises for the provision of late night refreshment at different times, to those listed in the column on the left, please list</u> (please read guidance note 6)		
Sat					
Sun					

J

Supply of alcohol Standard days and timings (please read guidance note 7)			Will the supply of alcohol be for consumption – please tick (please read guidance note 8)	On the premises	<input type="checkbox"/>
				Off the premises	<input type="checkbox"/>
				Both	<input checked="" type="checkbox"/>
Day	Start	Finish	State any seasonal variations for the supply of alcohol (please read guidance note 5)		
Mon	12 00	19 00			
Tue	12 00	19 00			
Wed	12 00	19 00			
Thur	12 00	19 00	Non standard timings. Where you intend to use the premises for the supply of alcohol at different times to those listed in the column on the left, please list (please read guidance note 6)		
Fri	17 00	19 00			
Sat	12 00	19 00			
Sun	12 00	19 00			

State the name and details of the individual whom you wish to specify on the licence as
designated premises supervisor (Please see declaration about the entitlement to work in the
checklist at the end of the form):

Name ENES SANLI	
Date of birth	[REDACTED]
Address [REDACTED]	
Postcode	[REDACTED]
Personal licence number (if known) [REDACTED]	
Issuing licensing authority (if known) [REDACTED]	

□□□□

K

Please highlight any adult entertainment or services, activities, other entertainment or matters ancillary to the use of the premises that may give rise to concern in respect of children (please read guidance note 9)

L

Hours premises are open to the public Standard days and timings (please read guidance note 7)			State any seasonal variations (please read guidance note 5)
Day	Start	Finish	
Mon	12:00	19:00	<p><u>Non standard timings. Where you intend the premises to be open to the public at different times from those listed in the column on the left, please list (please read guidance note 6)</u></p>
Tue	12:00	19:00	
Wed	12:00	19:00	
Thur	12:00	19:00	
Fri	12:00	19:00	
Sat	12:00	19:00	
Sun	12:00	19:00	

M Describe the steps you intend to take to promote the four licensing objectives

a) General – all four licensing objectives (b, c, d and e) (please read guidance note 10)

Strong management controls and effective training of all staff so that they are aware of the premises licence and the requirements to meet the four licensing objectives with particular attention to;

- No selling alcohol to underage people
 - No drunk and disorderly behaviour on the premises
 - Vigilance in preventing the use and sale of illegal drugs at the premises
 - No violent and anti-social behaviour
 - No any harm to children
- Operating schedule providing the hours of operating and licensable activities during those hours
- Designated Premises Supervisor confirms and obligated to be in day-to-day control of the premises, to provide good training for staff on the Licensing Act (Training Record_ to make or authorize each sale.
- Clear "Challenge 25" Information to prevent the supply of alcohol to under-age drinkers
- CCTV system installed with recording

As a licensed premise we know that is necessary to carry out our functions or operate the business with purpose of promoting these objectives. We promise to support these objectives through operating, schedule and other measures including staff training and qualifications, policies, and strategic partnership with other agencies

No binge drink promotions will take place
Any person who appeared to be drunk and disorderly will not permitted to premises
Notices will placed prominent positions to ask patrons to leave quietly
Suitable evacuation plan in case of any emergency

b) The prevention of crime and disorder

CCTV System installed to monitor entrances, exits, and other parts of the premises in order to address the prevention of crime objective.

A clear and legible notice outside the premises indicating the normal hours under the terms of the premises licence during which licensable activities are permitted.

Clear and conspicuous notices warning of potential criminal activity, such as theft, that may target customers will be displayed.

Not selling of alcohol to drunk or intoxicated customers.

Custom will not be sought by means of personal solicitation outside or in the vicinity of the premises.

Prevention and vigilance in illegal drug use at the premises.

Staff will be well trained in asking customers to use premises in an orderly and

respectful manner and prevent drinking alcohol at the premises (ex. canned or bottled beer).

c) public safety

Internal and external lighting fixed to promote the public safety objective.
Well trained staff adherence to environmental health requirements.
Training and implementation of underage ID checks.

A log book or recording system shall be kept upon the premises in which shall be entered particulars of inspections made; those required to be made by statute, and information compiled to comply with any public safety condition attached to the premises licence that requires the recording of such information. The logbook shall be kept available for inspection when required by persons authorised by the Licensing Act 2003 or associated legislation.

All parts of the premises and all fittings and apparatus therein, door fastenings and notices, lighting, heating, electrical, air condition, sanitary accommodation, and other installations, will be maintained at all times in good order and in a safe condition

d) The prevention of public nuisance

Prominent clear and legible notices will be displayed at the exit requesting the public to respect the needs of nearby residents and to leave the premises and the area quietly.

Deliveries of goods necessary for the operation of the business will be carried out at such a time or in such a manner as to prevent nuisance and disturbance to nearby residents.

The Licensee will ensure that staff who arrive early morning or depart late at night (ex. for unpacking, pricing newly delivered goods) when the business has ceased trading conduct themselves in such a manner to avoid causing disturbance to nearby residents.

Customers will be asked not to stand around loudly talking in the street outside the premises.

Customers will not be admitted to premises above opening hours.

The movement of bins and rubbish outside the premises will be kept to a minimum. This will help to reduce the levels of noise produced by the premises.

Any lighting on or outside the premises will be positioned and screened in such a way so as to not cause a disturbance to nearby residents.

Adequate waste receptacles for use by customers will be provided in the local vicinity.

c) The protection of children from harm

Challenge 25" sign which is a retailing strategy that encourages anyone who is over 18 but looks under 25 to carry acceptable ID (a card bearing the PASS hologram, a photographic driving license or a passport) if they wish to buy alcohol. Well trained staff about requirement for persons' identification, age establishment etc. All the details provided in Training Record Book available the retail unit. Logbook will be kept upon the premises all the time. Nothing belong existing Health & Safety requirements.

Checklist:

Please tick to indicate agreement

- I have made or enclosed payment of the fee. ☒
- I have enclosed the plan of the premises. ☒
- I have sent copies of this application and the plan to responsible authorities and others where applicable. ☐
- I have enclosed the consent form completed by the individual I wish to be designated premises supervisor, if applicable. ☒
- I understand that I must now advertise my application. ☒
- I understand that if I do not comply with the above requirements my application will be rejected. ☒
- ☐ [Applicable to all individual applicants, including those in a partnership which is not a limited liability partnership, but not companies or limited liability partnerships] I have included documents demonstrating my entitlement to work in the United Kingdom (please read note 15). ☒

IT IS AN OFFENCE, UNDER SECTION 158 OF THE LICENSING ACT 2003, TO MAKE A FALSE STATEMENT IN OR IN CONNECTION WITH THIS APPLICATION. THOSE WHO MAKE A FALSE STATEMENT MAY BE LIABLE ON SUMMARY CONVICTION TO A FINE OF ANY AMOUNT.

IT IS AN OFFENCE UNDER SECTION 24B OF THE IMMIGRATION ACT 1971 FOR A PERSON TO WORK WHEN THEY KNOW, OR HAVE REASONABLE CAUSE TO BELIEVE, THAT THEY ARE DISQUALIFIED FROM DOING SO BY REASON OF THEIR IMMIGRATION STATUS. THOSE WHO EMPLOY AN ADULT WITHOUT LEAVE OR WHO IS SUBJECT TO CONDITIONS AS TO EMPLOYMENT WILL BE LIABLE TO A CIVIL PENALTY UNDER SECTION 15 OF THE IMMIGRATION, ASYLUM AND NATIONALITY ACT 2006 AND PURSUANT TO SECTION 21 OF THE SAME ACT, WILL BE COMMITTING AN OFFENCE WHERE THEY DO SO IN THE KNOWLEDGE, OR WITH REASONABLE CAUSE TO BELIEVE, THAT THE EMPLOYEE IS DISQUALIFIED.

Declaration	<ul style="list-style-type: none"> [Applicable to individual applicants only, including those in a partnership which is not a limited liability partnership] I understand I am not entitled to be issued with a licence if I do not have the entitlement to live and work in the UK (or if I am subject to a condition preventing me from doing work relating to the carrying on of a licensable activity) and that my licence will become invalid if I cease to be entitled to live and work in the UK (please read guidance note 15). The DPS named in this application form is entitled to work in the UK (and is not subject to conditions preventing him or her from doing work relating to a licensable activity) and I have seen a copy of his or her proof of entitlement to work, if appropriate (please see note 15)
Signature	
Date	30/11/2021
Capacity	DPS

For joint applications, signature of 2nd applicant or 2nd applicant's solicitor or other authorised agent (please read guidance note 13). If signing on behalf of the applicant, please state in what capacity.

Signature	
Date	
Capacity	

Contact name (where not previously given) and postal address for correspondence associated with this application (please read guidance note 14)			
Post town		Postcode	
Telephone number (if any)			
If you would prefer us to correspond with you by e-mail, your e-mail address (optional)			

Notes for Guidance

- Describe the premises, for example the type of premises, its general situation and layout and any other information which could be relevant to the licensing objectives. Where your application includes off-supplies of alcohol and you intend to provide a place for consumption of these off-supplies, you must include a description of where the place will be and its proximity to the premises.
- In terms of specific regulated entertainments please note that:

Legend

- Boundary
- Licencable Activity Area
- Fire And Emergency Exit Light

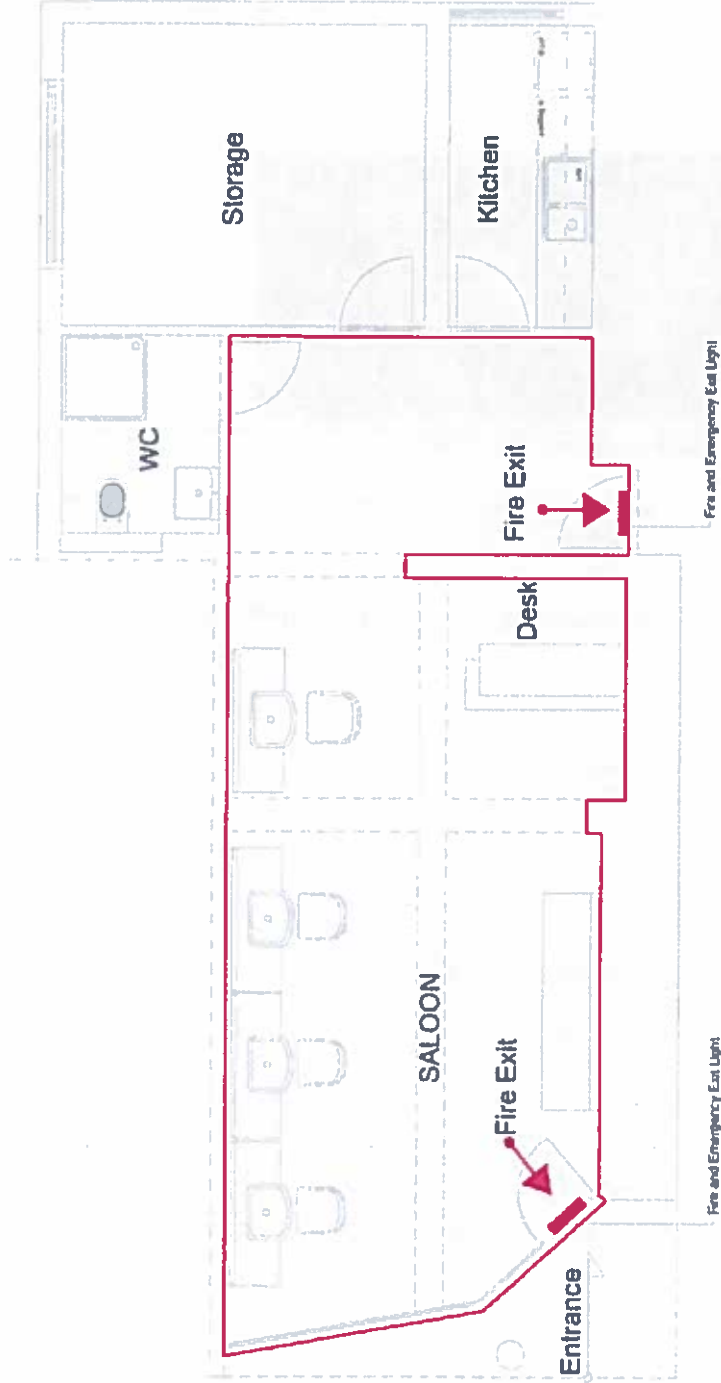

<p>AVARCH 110</p> <p>AVARCH 110</p> <p>AVARCH 110</p>	
<p>AVARCH 110</p> <p>AVARCH 110</p> <p>AVARCH 110</p>	<p>AVARCH 110</p> <p>AVARCH 110</p> <p>AVARCH 110</p>

FLOOR PLAN

Consent of individual to being specified as premises supervisor

ENES SANLI

I

(full name of prospective premises supervisor)

of



(home address of prospective premises supervisor)

hereby confirm that I give my consent to be specified as the designated premises supervisor in relation to the application for

Premises Licence Application

(type of application)

by

ENES SANLI

(name of applicant)

relating to a premises licence

(number of existing licence, if any)

for ARAN'S BARBER

38 HOLT ROAD

LEPPING

CM16 6BU

(name and address of premises to which the application relates)

and any premises licence to be granted or varied in respect of this application made by

ENES SANLI

(name of applicant)

concerning the supply of alcohol at

ARAN'S BARBER

38 HIGH ROAD

EPHING

CM16 6BU

(name and address of premises to which application relates)

I also confirm that I am entitled to work in the United Kingdom and am applying for, intend to apply for or currently hold a personal licence, details of which I set out below.

Personal licence number



(insert personal licence number, if any)

Personal licence issuing authority



(insert personal licence issuing authority, if any)

Signed



Name (please print)

ENES SANLI

Date

30 / 11 / 2021

**Notice of Application for a New Premises Licence under
the Licensing Act 2003**

Notice is given this day 30th December that ENES SAVI
of 35 HIGH STREET, WICKFORD, SS12 9AE has applied
to the Licensing office of Epping Forest District Council for
a Premises Licence in respect of ARAN'S BARBERS 38
HIGH ROAD, EPPING CM16 6BU

The proposed licence is for: The Sale by Retail of Alcohol ON
and OFF the premises Monday to Sunday 12.00 – 19.00pm,

The Opening times will be Monday to Sunday 12.00 – 19.00pm.

The register of licensed premises is maintained at the
Licensing Office of Epping Forest District Council, Civic
Offices, High Street, Epping, Essex, CM16 4BZ.
Applications for premises licences may be inspected at
this office during office hours. Anyone wishing to oppose
this application must give written notice to the Licensing
Office within 28 days of this notice.

It is an offence knowingly or recklessly to make a false
statement in connection with an application which could
lead to a fine on summary conviction (maximum £5000)

Legal Notices

Notice of Application for a New Premises License
under the Licensing Act 2003

Notice is given this day 9th December that SKEE SAMUEL of 25 HIGH STREET, WICKFORD, SS17 5AG has applied to the Licensing office of Epping Forest District Council for a Premises License in respect of ALBERT BARBERS 25 HIGH ROAD, EPPING, CM16 5BU. The proposed license is for THE SALE OF ALCOHOL ON AND OFF THE PREMISES MONDAY TO SUNDAY 12.00 UNTIL 10.00. THE OPENING TIMES WILL BE MONDAY TO SUNDAY 12.00 UNTIL 10.00. The register of licensed premises is maintained at the Licensing Office of Epping Forest District Council, Civic Centre, High Street, Epping, Essex, CM16 4BZ. Applications for premises licenses may be inspected at the office during office hours. Anyone wishing to oppose this application must give written notice to the Licensing Office within 28 days of the notice. It is an offence knowingly or recklessly to make a false statement in connection with an application which could lead to a fine or summary conviction (maximum £5000).
Last Representation Date: 29th December 2021

Subject: RE: 38 High Road Epping Essex CM16 6BU Barbers Shop

Date: 15/12/2021 16:37

From: "Susan De Luca" <Clerk@northweald-pc.gov.uk>

To: "Debbie Houghton" <doughton@eppingforestdc.gov.uk>

Cc: "Chairman" <Chairman@northweald-pc.gov.uk>, [REDACTED]

CAUTION: This Message originated outside of Epping Forest District Council. Do not click links or open attachments unless you recognise the sender and know the content is safe.

Dear Debbie

On behalf of the Parish Council

I wish to advise that the Parish Council discussed this application at considerable length and the following comments were made after which it was agreed that a **STRONG OBJECTION** to this application should be put in.

- 1 There is a strong possibility of selling alcohol to underage people which would encourage an increase in anti social behaviour
- 2 Harm to children and young people under 18
- 3 Could encourage drunk and disorderly behaviour both on and off the premises
- 4 Can not guarantee that alcohol would not be sold to customers who have already consumed alcohol elsewhere, so could already be intoxicated
- 5 Customers could ask others to purchase alcohol for them
- 6 There is already concern that drugs are being bought and sold illegally in the parish (police are aware) this could add to the problem.
- 7 People being intoxicated during the day time and driving their vehicles therefore increase to the public safety by Drink Driving
- 8 Lack of Parking and increase in Noise Levels thereby causing a public nuisance to local residents.

I will advise Members of your recent email advising that the Applicant has amended it to ON Premises Sales only and ask if they would like to make any amendments.

Regards

Susan

From: Debbie Houghton <doughton@eppingforestdc.gov.uk>

Sent: 02 December 2021 10:24

To: Essex Police (Licensing.Applications@essex.police.uk) <Licensing.Applications@essex.police.uk>; Essex Fire Rescue (SouthWestGroupSDP@essex-fire.gov.uk) <SouthWestGroupSDP@essex-fire.gov.uk>; Environmental Health <EnvironmentalHealth@eppingforestdc.gov.uk>; Richard Thomason <RThomason@eppingforestdc.gov.uk>; Brian Stalabrass <BStalabrass@eppingforestdc.gov.uk>; The Home Office <Alcohol@homeoffice.gsi.gov.uk>; Licence Applications CYP <LicenceApplications@essex.gov.uk>; Contact Planning <contactplanning@eppingforestdc.gov.uk>; Trading.Standards@Essex.gov.uk

Cc: Susan De Luca <Clerk@northweald-pc.gov.uk>; Cllr.P Bolton <cllr.pbolton@eppingforestdc.gov.uk>; Cllr.J McIvor <cllr.jmcivor@eppingforestdc.gov.uk>; Cllr.C Whitbread <cllr.cwhitbread@eppingforestdc.gov.uk>; h.berkpinar@oneZoneconsultancy.co.uk

Subject: 38 High Road Epping Essex CM16 6BU Barbers Shop

Good morning,

Please find attached an application and plans for a new premises licence at the above address, this application is for a barbers shop,

The application is for

The Sale by Retail of Alcohol On and Off the premises Monday to Sunday 12.00 – 19.00pm,

The Opening times will be Monday to Sunday 12.00 – 19.00pm,

about:blank

20/12/2021

The consultation is from 2nd December 2021 – 29th December 2021, any comments or representations must be received within this time period

This application may contain personal information, this is not for sharing or 3rd party use

Miss Debbie Houghton

Licensing Officer

Licensing Team,

Commercial and Regulatory Directorate

Tel: 01992 564336 Mobile 07704073743 remotely working until further notice

E-mail: dhoughton@eppingforestdc.gov.uk

Epping Forest District Council

www.eppingforestdc.gov.uk



Safer spaces is a council-led programme to help kickstart the local economy and reopen high streets in the Epping Forest district [Click Here to have your say on social distancing and safer spaces](#)



Our employees are working from home and have access to emails and telephones. We are doing everything we can to support our residents and local businesses. To avoid risk of cross-contamination please don't send items and correspondence through the post unless absolutely necessary. For up to date information and service updates go to our website at www.eppingforestdc.gov.uk. Stay alert. Control the virus. Save lives.

Disclaimer Epping Forest District Council

If you received this email by mistake, please let us know and delete it. We ask you to respect any confidential or private information in the email. Do not share it unless appropriate to do so. We take precautions to minimise risk but we cannot guarantee the safety, confidentiality and security of the internet. Please carry out your own virus checks on any attachments. We are not liable or bound by the content of this email. Our employees are fully responsible for the content of their emails and we expect them to remain within the law. However, the views expressed by our employees may not necessarily reflect the policies of Epping Forest District Council.

Steven Smith

High Road
North Weald
Epping
Essex

27 December 2021

Licensing Unit

The Licensing Team
Epping Forest District Council
Civic Offices
High Street
Epping
Essex
CM16 4BZ

By email to - licensing@eppingforestdc.gov.uk

Dear Sir/Madam

RE - REPRESENTATION OF OPPOSAL UNDER THE LICENSING ACT 2003 in relation to Register of Licence applications received at Arans Barber, 38 High Road, North Weald Bassett, Epping, Essex CM16 6BU

We write further to the Notification of Consultation received in respect to the Application by Enes Sanli at Arans Barber, 38 High Road, North Weald, Epping as we are direct neighbours to the premises.

We oppose this licence on based on the following grounds:

The prevention on crime and disorder

We already have several establishments in the Village selling alcohol and question why a barbers shop would want a licence to sell alcohol both on and OFF the premises from noon until 7pm every day of the week which has the potential to lead to it becoming a risk to attracting crime and disorder to this very residential area of the Village.

Public Safety

Yet another alcohol licensed premises poses a risk to public safety as it may lead to becoming a magnet for anti social behaviour and hanging around causing crowds to gather and intimidating behaviour to the residents.

The prevention of public nuisance

As stated above, the hours of the licence are unreasonable and granting this licence could encourage public nuisance as 7 days a week is too much and is not in keeping with the residential/commercial balance needed for harmony in this largely residential area.

The protection of children from harm

We already have issues with anti-social behaviour with youths in the Village and yet another alcohol licenced premises could pose a risk to children by way of underage sales of alcohol and being able to access the premises where the alcohol is supplied from.

Yours faithfully

Steven Smith

Mr C Smith,
[REDACTED] High Road,
North Weald,
Epping,
Essex.
[REDACTED]

The Licensing Team,
Epping Forest District Council,
Civic Offices,
High Street,
Epping,
Essex,
CM16 4BZ

27th December 2021

**RE: APPLICATION FOR THE RETAIL SALE OF ALCOHOL ON AND OFF
THE PREMISES AT 38, HIGH ROAD, NORTH WEALD BASSETT,EPPING
ESSEX. CM16 6BU BY ENES SANLI OF ARANS BARBERS.**

To who it may concern,

I live [REDACTED] to the above Premises, and my neighbours at number [REDACTED] High Road, and I will be most affected by the sale of Alcohol on these Premises which only a few weeks ago opened as a Barbers.

I Strongly object to the Application which is in a predominantly residential area for the following reasons.

The prevention of crime and disorder.

The sale of Alcohol from these premises will encourage the loitering of local youths who already cause more than enough trouble in the Village, this will be a focal point for them, and my neighbours and I will receive more abuse,more threats, damage to our Property,and of course,Beer cans,Bottles, and litter thrown into our property. There are more than enough outlets selling Alcohol now, we certainly don't need anymore.

Public Safety

There is insufficient Parking space on the forecourt that the extra traffic

(2)

Will cause, which will result in vehicles parking illegally on the very busy main road and the footpath which is highly dangerous as many children and elderly people constantly use this.

The prevention of public nuisance

The licenced hours are totally unreasonable 7 days a week until 7PM in an overwhelming residential area, this will involve car engines revving, doors slamming in the EVENING and most of the SUNDAY which will ruin our Quality of life, we are entitled to some peace and quite.

The protection of children from harm

As already stated the danger to children by the illegal parking this Application will cause, underage children will attempt to obtain Alcohol from these premises one way or another which could help generate the next phase of anti-social behaviour by youths.

This suppose to be a Barbers, seems strange that only after being open only a very few weeks they want to open as more or less a PUB.

Yours faithfully

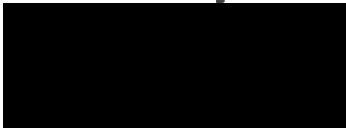
A black rectangular box redacting the signature of Colin Smith.

Colin Smith

Kelsey Dott 42081335

From: Aran's Barber <aransbarber21@hotmail.com>
Sent: 21 December 2021 18:50
To: Licensing Epping and Brentwood
Subject: EXTERNAL - Re: Arans Barber Shop, Epping, CM166BU

CAUTION: This email originated from outside of the organization. Do not click links or open attachments unless you recognize the sender and know the content is safe.

HI DEAR

SURELY WE WILL ADD THAT DETAILS TO LICENCE

BEST REGARDS

ENES ŞANLI

Licensing Epping and Brentwood <licensing.epping.and.brentwood@essex.police.uk> şunları yazdı
(13 Ara 2021 16:01):

Good Afternoon Mr Sanli,

Following on from our phone conversation you advised me that you are a barber shop that wishes to supply customers who are having a hair cut with a beer. You do not wish for the off sales of alcohol, only the on sales.

Essex Police feel that these conditions should be added onto the licence:

- No alcohol may be supplied by an individual unless that individual has the written consent of the Designated Premises Supervisor or other employed Personal Licence Holder.
A written record of this consent must be retained on the premises at all times when such an individual supplies or proposes to supply alcohol and be made available immediately upon reasonable request of the police or licensing authority.
- CCTV
 - 1) CCTV Equipment must be maintained in good working order, be correctly time and date stamped, recordings must be kept in good working order and kept for a minimum period of 31 days.
 - 2) At all times, whilst the premises is open for licensable activities, there are members of staff able to immediately provide viewable copies of recordings to the police or licensing authority staff upon reasonable request.
- All staff engaged in the sale or supply of alcohol on the premises shall have received training in relation to the protection of children from harm (including under-age sales), how to recognise drunkenness and the duty not to serve drunk persons. Refresher training shall be carried out at least every six months.
Training records shall be kept on the premises (or otherwise be accessible on the premises) for a minimum of 12 months and made immediately available to police, trading standards or licensing authority staff upon reasonable request.

- A refusals record shall be maintained at the premises that details all refusals to sell alcohol. Each entry shall, as a minimum, record the date and time of the refusal and the name of the staff member refusing the sale.
All entries must be made as soon as possible and in any event within 4 hours of the refusal and the record must be made immediately available to police, trading standards or licensing authority staff upon reasonable request.
The refusals record shall be either electronic or maintained in a bound document and retained for at least 12 months from the date of the last entry.
- The premises must operate as a Barbers:
 - 1) Where alcohol must not be sold, supplied otherwise than to customers who are attending the barbers primarily for a haircut.
 - 2) Which do not provide any takeaway service of alcohol.

Kind regards,



Kelsey Dott (81335)

Licensing Officer

📠 101 (Ext: 313604) 📞 07817 154048

📍 Loughton Police Station, 158 High Road, Loughton, IG10 1DX

This email and any other accompanying document(s) contain information from Kent Police and/or Essex Police, which is confidential or privileged. The information is intended to be for the exclusive use of the individual(s) or bodies to whom it is addressed. The content, including any subsequent replies, could be disclosable if relating to a criminal investigation or civil proceedings. If you are not the intended recipient, be aware that any disclosure, copying, distribution or other use of the contents of this information is prohibited. If you have received this email in error, please notify us immediately by contacting the sender or telephoning Kent Police on 01622 690690 or Essex Police on 01245 491491, as appropriate. For further information regarding Kent Police's or Essex Police's use of personal data please go to <https://www.kent.police.uk/hyg/privacy/> or <https://www.essex.police.uk/hyg/privacy/>. Additionally for our Terms and Conditions please go to <https://www.kent.police.uk/hyg/terms-conditions/> or <https://www.essex.police.uk/hyg/terms-conditions/>